



Bath Road, Worthing, BN11 3PA

Guide Price £130,000

We are delighted to bring to market this first-floor studio apartment, ideally positioned in the heart of the town centre, just off the seafront. Perfectly placed for access to shops, restaurants, schools, parks and the mainline station, the property combines convenience with comfort. The apartment is entered via a secure communal hallway and comprises an entrance lobby, a spacious double-aspect studio room with space for living, dining and sleeping areas, and a fitted kitchen offering wall and base units, integrated oven and hob, and space for further appliances. The recently refitted modern shower room provides a stylish suite with shower enclosure, wash hand basin and low-level W.C. Further benefits include a security entry system, electric heating and access to large, south-facing communal gardens, ideal for enjoying outdoor space in a central location. The property is offered with a share of freehold and the remainder of a 999-year lease, with no ground rent and a service charge of £89 per month, making it a fantastic opportunity.



Council Tax Band: A

- First-floor studio in prime location
- Spacious living with dining space
- Recently refitted modern shower room
- Security entry phone for access
- Service charge only £89 per month
- Just off seafront, shops and station
- Fitted kitchen with integrated oven
- South-facing communal gardens to rear
- Share of freehold, 999-year lease
- Unrestricted parking along Bath Road



Worthing, a charming seaside town on the south coast of England, strikes a balance between Victorian elegance and contemporary energy. Its extensive pebble beach, historic pier and scenic promenade make for a quintessential coastal experience. A thriving cultural scene, including theatres, galleries and local events, brings vibrancy to the town. With lush green spaces such as Beach House Park and Highdown Gardens, plus a bustling town centre full of shops, restaurants and entertainment, Worthing is a well-connected, welcoming community with a rich history and enduring appeal.

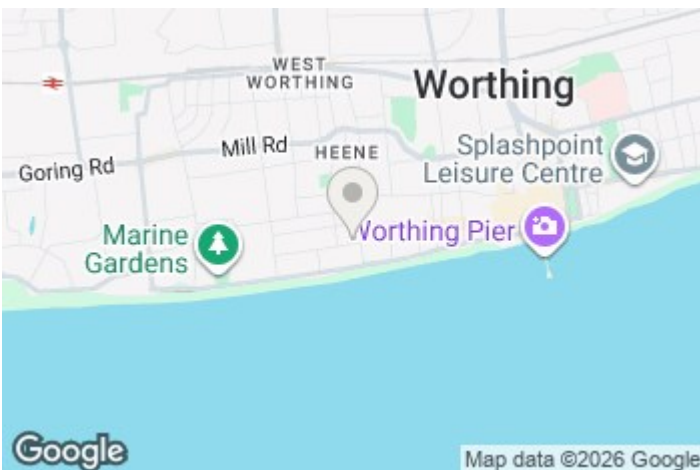
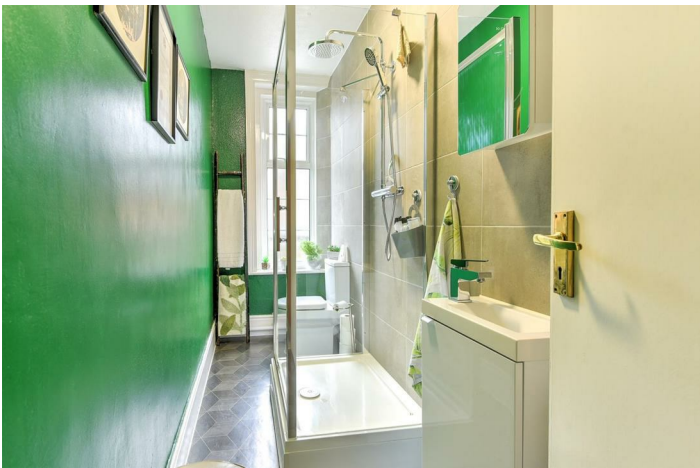

EPC Rating:

E

Energy Efficiency Rating		Current	Potential
Very energy efficient - lower running costs			
(92 plus)	A		
(81-91)	B		
(69-80)	C		79
(55-68)	D		
(39-54)	E	40	
(21-38)	F		
(1-20)	G		
Not energy efficient - higher running costs			
England & Wales		EU Directive 2002/91/EC	

First Floor
26.4 sq.m. (285 sq.ft.) approx.

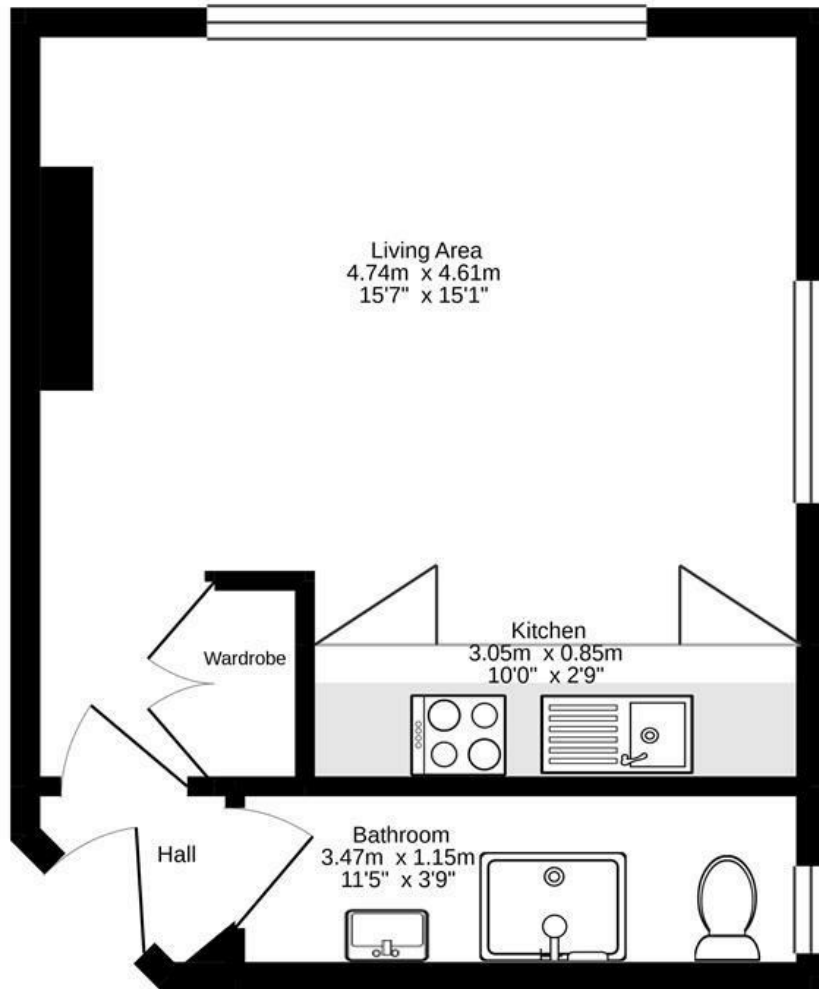

TOTAL FLOOR AREA : 26.4 sq.m. (285 sq.ft.) approx.

Made with Metropix ©2021

Aspire Residential | Goring-by-Sea

28 Goring Road
Goring-by-Sea
Worthing
BN12 4AD
Telephone: 01903 259 961
Email: info@aspireresidential.co.uk



Aspire Residential | Durrington / Salvington

5 Selden Parade
Salvington Road
Worthing
BN13 2HL
Telephone: 01903 910 424
Email: enquiries@aspireresidential.co.uk

Aspire Residential and Aspire Residential Estate Agents are trading names of Aspire Residential Sales Limited, a Company registered in England and Wales with registration number 11659289. VAT No. 317450614

IMPORTANT NOTICE TO PURCHASERS: We endeavour to make our sales particulars accurate and reliable, however, they do not constitute or form part of an offer or any contract and none is to be relied upon as statements of representation or fact. The services, systems and appliances listed in this specification have not been tested by us and no guarantees as to their operating ability or efficiency are given. All measurements have been taken as a guide to prospective buyers only, and are not precise. If you require clarification or further information on any points, please contact us, especially if you are traveling some distance to view.